

Mojave Desert A.W.A.C.

# Prototypical Front Yard

Thornless Front Yard Landscape



*Original Landscape*



*New Water-Efficient Landscape*

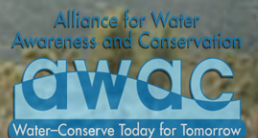



# Planting Palette

## Trees



**Thornless Honey Mesquite**  
(*Prosopis glandulosa*)



**Strawberry Tree**  
(*Arbutus unedo*)

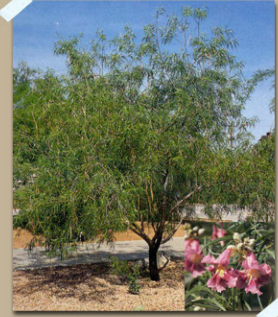

**Desert Willow**  
(*Chilopsis linearis*)

## Large Shrubs



**Hollyleaf Cherry**  
(*Prunus ilicifolia*)



**Brittlebush**  
(*Encelia farinosa*)



**Green Cloud**  
(*Leucophyllum frutescens*)



**Texas Olive**  
(*Cordia boissieri*)

## Medium Shrubs



**Deer Grass**  
(*Muhlenbergia rigens*)



**Cassia**  
(*Cassia nemophila*)



**Desert Sage**  
(*Salvia dorrii*)



**Cleveland Sage**  
(*Salvia clevelandii*)



**Bush Morning Glory**  
(*Convolvulus cneorum*)

## Small Shrubs



**Penstemon**  
(*Penstemon eatonii*)



**Desert Marigold**  
(*Baileya multiradiata*)



**Lavender Cotton**  
(*Santolina virens*)



**Evening Primrose**  
(*Oenothera caespitosa*)



**Paper Flower**  
(*Psilostrophe tagetima*)





# Front Yard Planting Plan



## Landscape Narrative

Cacti is not for everyone! If you have young children or just prefer plants without thorns, then a thornless garden may appeal to you. The plants in this garden offer a variety of flowers and leaf textures that will keep your garden looking interesting all year. Play with contrasting textures and colors by arranging small groups of plants that catch your eye. All of these plants are water wise and relatively low maintenance. Remember to space plants according to their mature size requirements!

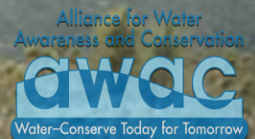
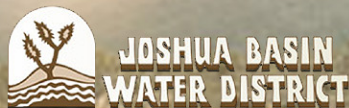



# Drip Irrigation

Drip irrigation can help you use water efficiently!



Smart Controller  
Using Real Time  
Weather Data



Gate Valve



Automatic Control Valve  
(Use Valve, Pressure Regulator,  
and Filter for Drip Zones.)



In-Line Check-Valve  
(Use on all slope areas  
and lowest heads)

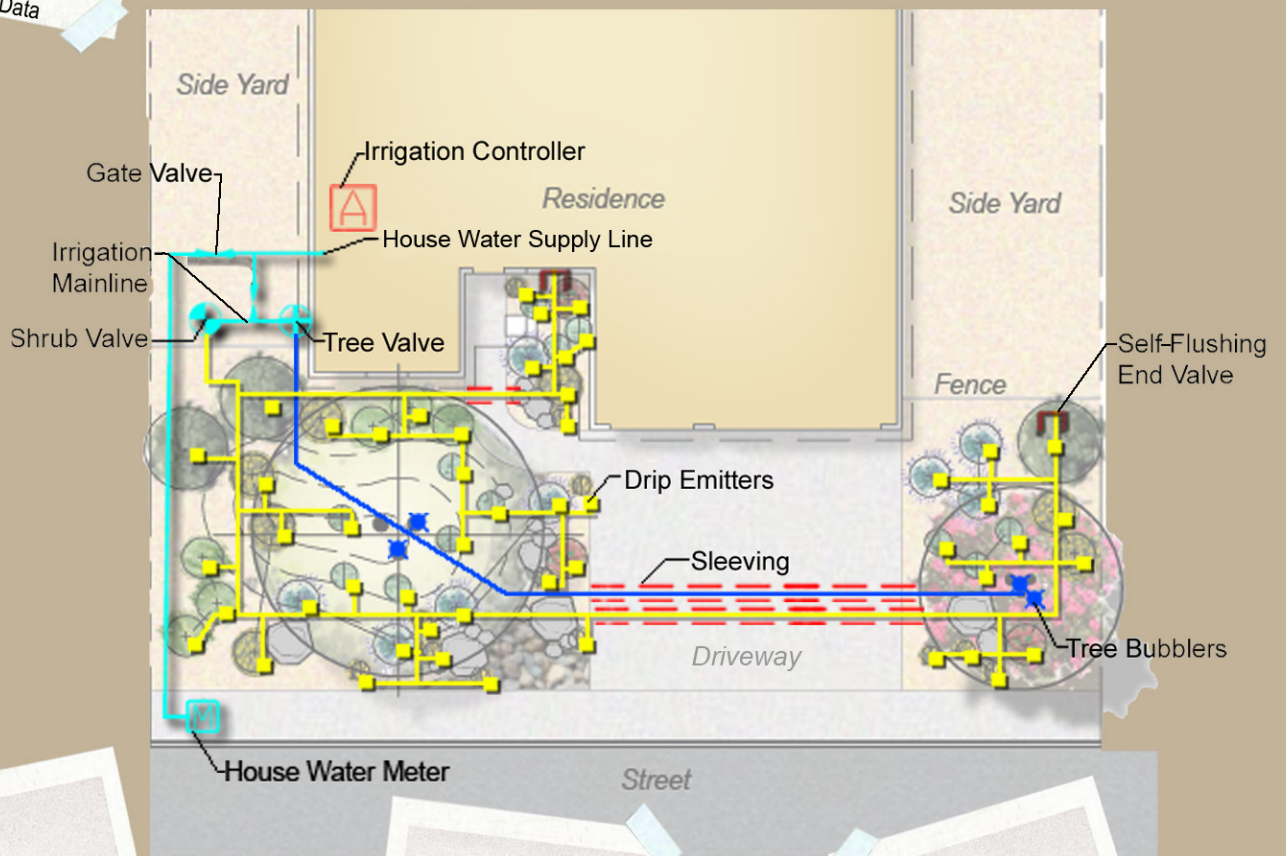

Self-Flushing End Valve

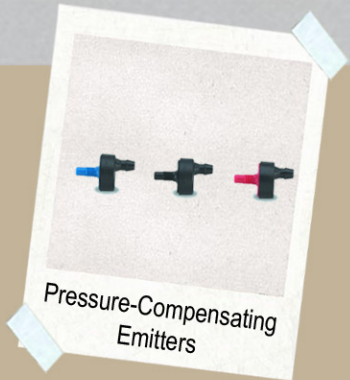

Pressure-Compensating  
Emitters



Fixed-Flow Bubbler

